

JAMESTOWN CLADDING & PROFILING LTD.



Continuing to service
to the Steel Sector:

Profiled Components Ex Mild Steel 0 - 150mm

- Oxy - Fuel Profiling
- High Speed Plasma Profiling
- High Definition Plasma Profiling

APPLICATIONS

- Steel Construction / Fabrication
- Agri-Machinery Parts
- Concrete & Quarry Equipment
- General Steel Fabrication
- Truck Body Sections
- Architectural Features
- Signage / Lettering
- Secondary Steelwork
- Heavy Vehicle Components
- Steel Flooring / Chequer Plate



**BASE PLATES • SLIM-FLOOR FLATS • TEE SECTIONS • HAUNCH SPLITTING • FLANGE PLATES
MACHINE COMPONENTS • CHEQUER-PLATE FLOORING • PLATE STRIPPING**



ALSO OFFERING: PLATE STRIPPING · BEAM SPLITTING · PLATE DRILLING

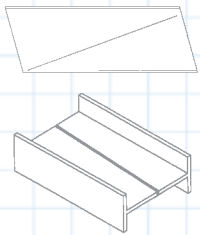

Haunches / Tees

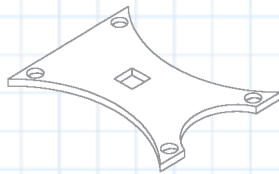

Profiled Plates

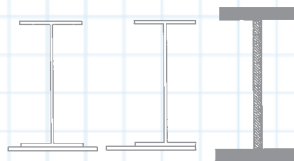

**PLT: Slimfloor Applications
Plate Girders**



Service Opes

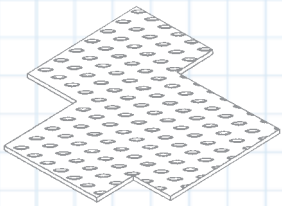

Chequer Plate Flooring

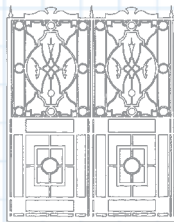

Architectural Features

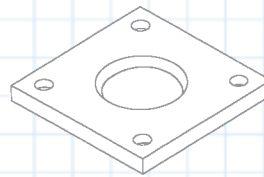

Base Plates



Castellation Cuts

25 TON LIFTING CAPACITY · LARGE PLATE STOCK · S355 GRADES AVAILABLE

**Inquiries to : JAMESTOWN CLADDING & PROFILING LTD.
Unit 20
Newbridge Ind. Est.
Newbridge
Co. Kildare**

**Tel.: (045) 434288
Fax: (045) 434308
E-Mail: cladding@sherlings.com**

(Profiling inquiries and general correspondence)

